

REVISIONS				
REV	ECO	DESCRIPTION	DATE	BY APPR
B1	-	RELEASE NEW DWG FORMAT	06/16/14	TOD TOMMY
B2	-	UPDTAED SPECIFICATION	09/14/15	TOD TOMMY

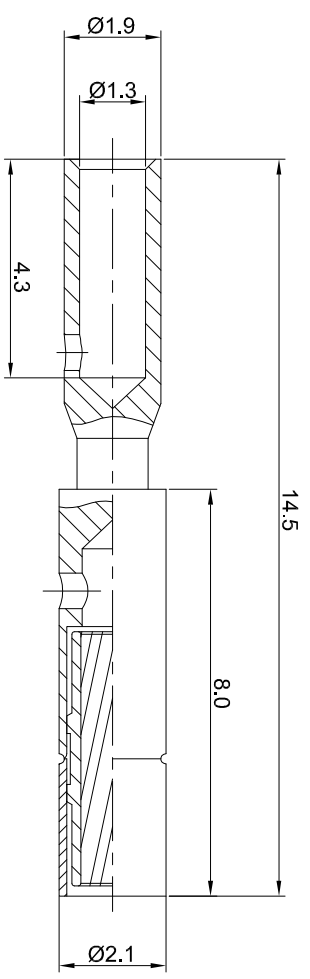

- NOTES: UNLESS OTHERWISE SPECIFIED
- MATERIAL: COPPER ALLOY; GOLD PLATED
 - SPECIFICATIONS:
 - 2.1 RATED CURRENT: 10 AMPS
 - 2.2 CONTACT RESISTANCE: <5 milliohm
 - 2.3 AVAILABLE WIRE RANGE: 18AWG~22AWG
 - 2.4 ROHS COMPLIANT
 - ALL DIMENSIONS ARE FOR REFERENCE USE ONLY.

QUANTITY	SEE PART NUMBER CHART	PART NUMBER	DESCRIPTION	ITEM
MATERIALS LIST				
UNLESS OTHERWISE SPECIFIED 1) All dimensions are in millimeters. 2) Tolerances are as follows: 1 Pl. DEC 20.00 2 Pl. DEC 20.00 3 Pl. DEC 20.08 3) Note reference =		DRAWN: tod	DATE: 09/14/15	
MATERIAL SPECIFICATIONS:		CHECKED:	ENGINEER:	APPROVAL:
PROCESS SPECIFICATIONS:		CUSTOMER:	Socket Contact, 20#, Chmp 18-22AWG	
NEXT ASSY:		THE DRAWING IS SUPPLIED FOR INFORMATION ONLY. DESIGN FEATURES, SPECIFICATIONS AND PERFORMANCE DATA ARE SUBJECT TO CHANGE WITHOUT NOTICE. THE APPLICABLE SPECIFICATION NO RIGHTS OF REPRODUCTION ARE IMPLIED. ALL MANUFACTURING VARIATIONS.		
SCALE: NONE		SIZE: B C- DWG NO: SC000013 SHEET 1 OF 1		

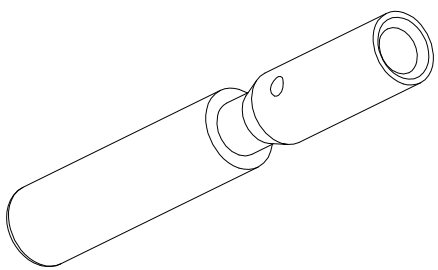

Amphenol

Sine Systems - www.amphenol-sine.com
44724 Moley Drive
Clifton Township, MI 48036